



Clinical Reviews 2015: 26th Annual Family Medicine and Internal Medicine Update

Program-At-A-Glance

Tuesday, March 24, 2015

4-6 p.m.	Early Registration	<i>Rainmakers Ballroom</i>
----------	---------------------------	----------------------------

Wednesday, March 25, 2015

7:00 a.m.	Registration/Continental Breakfast	<i>Herberger Foyer North</i>
-----------	---	------------------------------

7:50	Welcome Announcements	<i>Herberger 3, A, B, 4, 5</i>
------	------------------------------	--------------------------------

NEUROLOGY		<i>Herberger 3, A, B, 4, 5</i>
------------------	--	--------------------------------

8:00	Approach to Patients with Chronic Daily Headaches Bert B. Vargas, M.D.	
------	--	--

8:30	Redefining Parkinson's Disease Charles H. Adler, M.D., Ph.D.	
------	--	--

9:00	Stroke Maria I. Aguilar, M.D.	
------	---	--

9:30	Panel Q & A	
------	------------------------	--

10:00	Refreshment Break and Exhibits	<i>Herberger Foyer North</i>
-------	---------------------------------------	------------------------------

CARDIOLOGY		<i>Herberger 3, A, B, 4, 5</i>
-------------------	--	--------------------------------

10:20	ACC / AHA Guidelines for Lipid Management Susan M. Halli Demeter, D.N.P., R.N., C.N.P.	
-------	--	--

10:50	Percutaneous Vascular Intervention Samuel R. Money, M.D.	
-------	--	--

11:20	Heart Failure Evidence Based Robert L. Scott, M.D.	
-------	--	--

11:50	Panel Q & A	
-------	------------------------	--

Thursday, March 26, 2015

7:00 a.m. **Continental Breakfast** *Herberger Foyer North*

7:25 **Welcome Announcements** *Herberger 3, A, B, 4, 5*

GASTROENTEROLOGY *Herberger 3, A, B, 4, 5*

7:30 **Colon Cancer Screening**
Mark V. Larson, M.D.

8:00 **Gut Flora**
Amy E. Foxx-Orenstein, D.O.

8:30 **Management of Barrett's Dysplasia**
Herbert C. Wolfsen, M.D.

9:00 **Nonalcoholic Steatohepatitis (NASH)**
Elizabeth J. Carey, M.D.

9:30 **Q & A Panel**

10:00 **Refreshment Break and Exhibits** *Herberger Foyer North*

UROLOGY *Herberger 3, A, B, 4, 5*

10:20 **Kidney Stones**
Mitchell R. Humphreys, M.D.

10:50 **Prostate Specific Antigen (PSA)**
Murray S. Feldstein, M.D.

11:20 **New Diabetes Meds**
Sydney A. Westphal, M.D.

11:50 **Q & A Panel**

Thursday, March 26, 2015 (continued)

MEET THE PRECEPTOR LUNCHEONS

- 12:30 p.m. **Lunch** (*Please proceed directly to the respective concurrent session room identified below. Refer to your Registrant Sessions Report for the session you pre-selected.*)
- 1:00 **Lunch Concurrent Sessions (30 minute lunch/60 minute presentation)**
- J. Travel Medicine** *Rainmakers C*
 Steven S. Krotzer, M.D.
- K. Choosing Wisely** *Rainmakers B*
 Michael L. Grover, D.O.
- L. Seizures** *Kirkland*
 Joseph F. Drazkowski, M.D.
- M. Responsible Opioid Prescribing** *Herberger 1*
 Christopher S. Wie, M.D.
- N. Integrative Medical Therapy for Chronic Fatigue Syndrome and Myalgic Encephalomyelitis** *Herberger 2*
 Larry R. Bergstrom, M.D.
- O. Aging and Sarcopenia** *Rainmakers A*
 Nathan K. LeBrasseur, M.S., Ph.D.
- 2:00 **Refreshment Break and Exhibits** *Herberger Foyer North*
- 2:15 p.m. **AFTERNOON WORKSHOPS - (OPTIONAL SESSION)**
- P. Ultrasound (office based)** *Greenway*
 Joseph P. Wood, M.D.
- Q. “Need to Knows” About the Knee** *Herberger 4/5/A/B*
- **Examining the Knee:** Stephen F. Noll, M.D.
 - **Imaging the Knee:** Mark J. Kransdorf, M.D.
 - **Exercising the Knee:** Melissa R. Hatley, P.T., D.P.T.
 - **Injecting the Knee:** John A. Freeman, D.O.
 - **Supporting the Knee:** Kirsten S. Paynter, M.D.
 - **The (loose) Ends:** Stephen F. Noll, M.D.
- R. Five Apps You Should Be Using in Your Practice** *Herberger 3*
 Vernon D. Smith, M.D.
- 4:15 **Adjourn**

Friday, March 27, 2015

7:00 a.m.	Continental Breakfast	<i>Herberger Foyer North</i>
7:25	Welcome Announcements	<i>Herberger 3, A, B, 4, 5</i>
	POTPOURRI	<i>Herberger 3, A, B, 4, 5</i>
7:30	Venous Insufficiency (What Do You Do With Fat Feet?) Fadi E. Shamoun, M.D.	
8:00	Sarcoidosis Lewis J. Wesselius, M.D.	
8:30	Cervical Cancer Screening: What Else is New Lisa N. Kransdorf, M.D.	
9:00	Q & A Panel	
9:30	Refreshment Break and Exhibits	<i>Herberger Foyer North</i>
	ENDOCRINOLOGY	
9:50	How To Manage Behavior Problems Commonly Seen in Dementia Patients Darryl S. Chutka, M.D.	
10:20	Hypercalcemia: A Primer Michael D. Whitaker, M.D.	
10:50	Male Hypogonadism ‘Lo T’ Does Not A Diagnosis Make Michael D. Whitaker, M.D.	
11:20	Q & A Panel	
11:50	Adjourn	

Friday Afternoon (OPTIONAL SESSION)

1:00 p.m.	Cerebrovascular Disease ABFM Self-Assessment Module (SAM) John M. Wilkinson, M.D. and Bart M. Demaerschalk, M.D.	<i>Kirkland</i>
1:00	ABIM Maintenance of Certification (MOC) Amit K. Ghosh, M.D.	<i>Greenway</i>
5:00	Adjourn	

Saturday, March 28, 2015

7:00 a.m. **Continental Breakfast** *Herberger Foyer North*

7:25 **Welcome Announcements** *Herberger 3, A, B, 4, 5*

POTPOURRI

8:00 **Too High or Too Low?**
A Practical Approach to the Abnormal CBC
Joseph R. Mikhael, M.D.

8:40 **Psycho-oncology**
Robert P. Bright, M.D.

9:20 **Managing Patients with Multiple Chronic Conditions:**
Where Empathy Meets Generalism
Stewart W. Mercer, Ph.D., F.R.C.G.P.

10:00 **Q & A Panel**

10:30 **Refreshment Break and Exhibits** *Herberger Foyer North*

10:50 **Care of the Female Patient with**
Chronic Liver Disease
J. Eileen Hay, M.B., Ch.B.

11:20 **Papillary Thyroid Cancer: Presently**
Over-Diagnosed and Probably Over Treated
Ian D. Hay, M.D., Ph.D.

11:50 **Tingly Feet**
James C. Watson, M.D.

12:20 p.m. **Q & A Panel**

12:50 **Adjourn**

Clinical Reviews 2015 Meeting Rooms Westin Kierland Resort

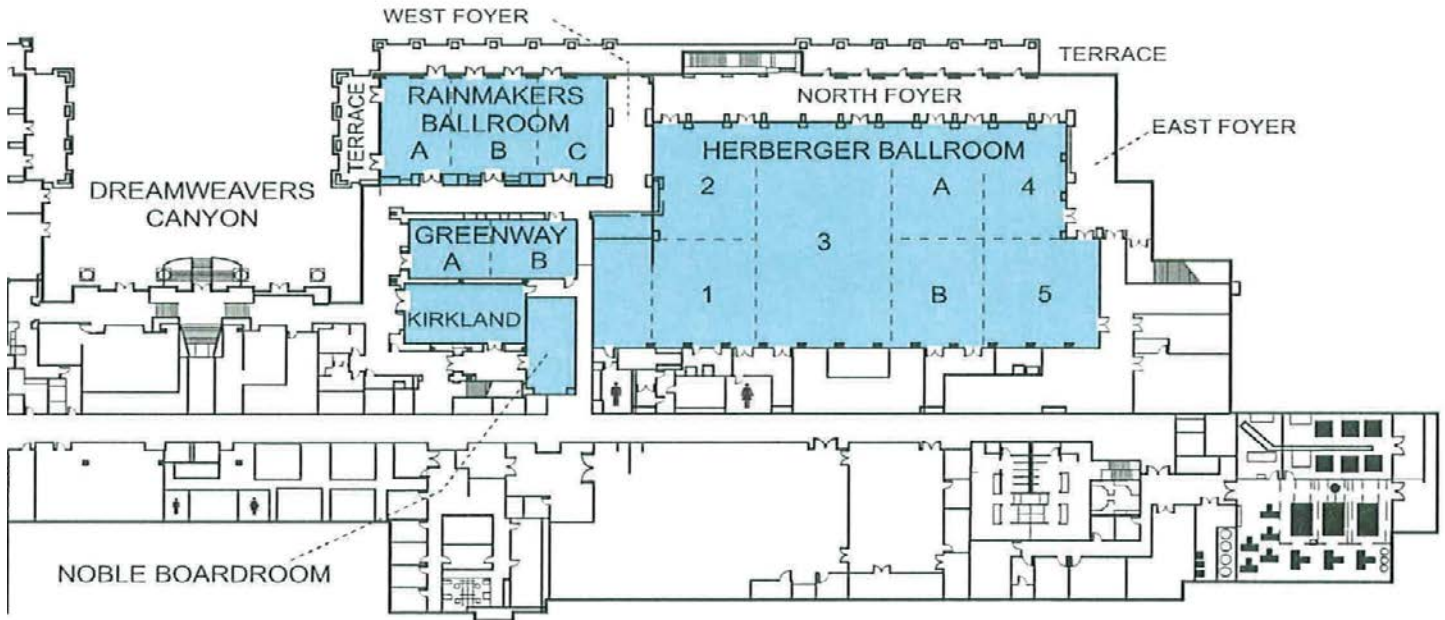

Wednesday			
Meet the Preceptor Luncheons & Workshops			
Session Title	MTP Room Location	Afternoon Workshop Title	Room Location
A) Travel Medicine	Herberger Ballroom 2	G) Dementia (Evaluation & Early Treatment)	Herberger 4/5/A/B
B) Choose Wisely	Rainmakers B	H) Management of Non-Cancer Pain	Herberger 3
C) Seizures	Rainmakers A	I) End of Life / Eating Disorders	Greenway
D) Responsible Opioid Prescribing	Herberger Ballroom 1		
E) Integrative Medical Therapy	Rainmakers C		
F) Aging and Sarcopenia	Kirkland		
Thursday			
Meet the Preceptor Luncheons & Workshops			
Session Title	MTP Room Location	Afternoon Workshop Title	Room Location
J) Travel Medicine	Rainmakers C	P) Ultrasound (Office Based)	Greenway
K) Choose Wisely	Rainmakers B	Q) Ortho-Management of Knee & Hip Pain	Herberger 4/5/A/B
L) Seizures	Kirkland	R) Five Apps You Should Be Using in Your Practice	Herberger 3
M) Responsible Opioid Prescribing	Herberger 1		
N) Integrative Medical Therapy	Herberger 2		
O) Aging and Sarcopenia	Rainmakers A		
Friday Afternoon — ABFM	SAM		Kirkland
Friday Afternoon — ABIM	MOC		Greenway