



In collaboration with Mayo Clinic Center for Tuberculosis

# 2025 BI-STATE INFECTIOUS DISEASE CONFERENCE

OCTOBER 3, 2025

Renaissance St. Louis Airport Hotel

9801 Natural Bridge Road  
St. Louis, Missouri 63134



EXHIBITOR PROSPECTUS





# **CONTENTS**

**Welcome**

**3**

**Date, Location, and Contacts**

**4**

**Conference Highlights**

**5**

**Exhibitor Information**

**6**

**Exhibit Hall Floor Plan**

**7**

**Hotel Accommodations**

**8**

**Rules and Regulations**

**9**

# Welcome

## Dear Exhibitors,

On behalf of the Missouri-Illinois Public Health Officials, APIC Chapter 73, and the Mayo Clinic Center for Tuberculosis, we invite you to participate in the 2025 Bi-State Infectious Disease Conference on October 3, 2025, at the Renaissance St. Louis Airport Hotel in St. Louis, Missouri.

The Bi-State Infectious Disease Conference was developed in 1996 as a collaborative effort of the local APIC Chapter 73, public health departments and school nurses in the Missouri and Illinois bi-state area.

The annual conference is designed to provide continuing education for healthcare professionals from Missouri and Illinois. It provides the most current information for disease intervention, detection, prevention, control and preparedness pertaining to infectious disease in order to provide optimal healthcare to our patients and to our community.

This course is designed for public health personnel, nurses, nurse practitioners, physicians, physician assistants, hospitalists, infectious disease specialists, infection preventionists, and healthcare professionals working in a public healthcare setting.

As an exhibitor, you will have a unique opportunity to showcase your products and services to a highly engaged audience, network with healthcare leaders, gain brand exposure, and contribute to advancing infectious disease management. We invite you to take advantage of this unparalleled opportunity to connect, educate, and make a meaningful impact in the fight against infectious diseases. For more details and to view the full program, please visit the [Bi-State Infectious Disease Conference event page](#).

We look forward to your participation in making this event a success.

Sincerely,



James Gaensbauer, MD, MScPH

*Course Director*

## Date and Location

### Event Date

October 3, 2025

### Event Location

Renaissance St. Louis Airport Hotel  
9801 Natural Bridge Road  
St. Louis, Missouri 63134

### Key Contacts

Rebecca Mussack: [tbcenter@mayo.edu](mailto:tbcenter@mayo.edu)

Elaine Allrich: [elaine.allrich@ssmhealth.com](mailto:elaine.allrich@ssmhealth.com)





# Conference Highlights

The 2025 Bi-State Infectious Disease Conference will feature expert-led discussions on key topics related to infectious disease diagnosis, treatment and prevention. Sessions provide practical, evidence-based insights to address current challenges and advancements.

## Presentation Topics include:

- Current trends in infectious disease surveillance
- Strategies for infection prevention and control in healthcare and community settings
- Public health response to vaccine-preventable diseases
- Evidence-based approaches to antibiotic use and infection management in healthcare settings
- Role of public health institutions in emergency preparedness, outbreak response, and health communication

## Why Exhibit?

Exhibiting at the 2025 Infectious Disease Conference on October 3, 2025, at the Renaissance St. Louis Airport Hotel in St. Louis, Missouri provides a unique opportunity to showcase your products and services to a highly engaged audience of healthcare professionals, connect with key decision-makers, enhance brand visibility, and support cutting-edge education in infectious disease prevention and control. Don't miss this chance to network, collaborate, and contribute to advancements in infectious disease management.

Here are some compelling reasons for being at this event:

## Benefits:

**Engage with Experts** – Connect with healthcare professionals.

**Boost Brand Visibility** – Showcase your company to key decision-makers.

**Expand Your Network** – Build relationships with industry leaders and peers.

**Community Contribution** – Support regional healthcare advancements in public health.

## EXHIBITOR INFORMATION

### Exhibitor Table Assignments

Table assignments will be determined upon receipt of full payment. **“Sold”** tables will be updated on the Exhibitor Registration Website.

Every effort will be made to give exhibitors their first choice of location. In case of conflicting requests, priority will be determined based on:

1. Date the application and payment were received by Mayo Clinic Center for Tuberculosis
2. Special needs of the exhibitors

### Exhibitor Table Registration Fee - \$450

*Availability: 29 Tables Available*

- One 6' exhibitor table with cloth table covering
- Complimentary name tags
- Full day of networking opportunities
- Complementary light breakfast and lunch buffet services for one representative. [Additional lunches](#) can be ordered for an additional charge.

### Exhibitor Letter of Agreement

Go to the [2025 Bi-State Infectious Disease Conference Letter of Agreement Form](#) to reserve your spot. You will receive an email confirmation once confirmation of payment and table assignment has been designated.

## EXHIBITOR SET-UP

Beginning on Thursday, October 2<sup>nd</sup> at 4 PM

## EXHIBIT HOURS

Friday, October 3<sup>rd</sup> from 7 AM – 3 PM

## SHIPPING INFORMATION

Materials may be shipped to the Renaissance St. Louis Airport Hotel but must be labeled with the name of the conference and date (Bi-State Infectious Disease Conference, October 3, 2025). All shipments must be received by Tuesday, September 30th. The shipping address is below:

**Renaissance St. Louis Airport Hotel**

**ATTN: Bi-State Infectious Disease Conference | October 3, 2025**

**9801 Natural Bridge Road**

**St. Louis, MO 63134**

## EXHIBITOR CONTACTS

Rebecca Mussack | [tbcenter@mayo.edu](mailto:tbcenter@mayo.edu)  
Elaine Allrich | [elaine.allrich@ssmhealth.com](mailto:elaine.allrich@ssmhealth.com)

## Exhibitor Floorplan

Exhibitors may request a preferred table number; however, table assignments are not guaranteed and will be confirmed on a first-come, first-served basis. After submissions are reviewed, exhibitors will receive an email with their assigned table number.

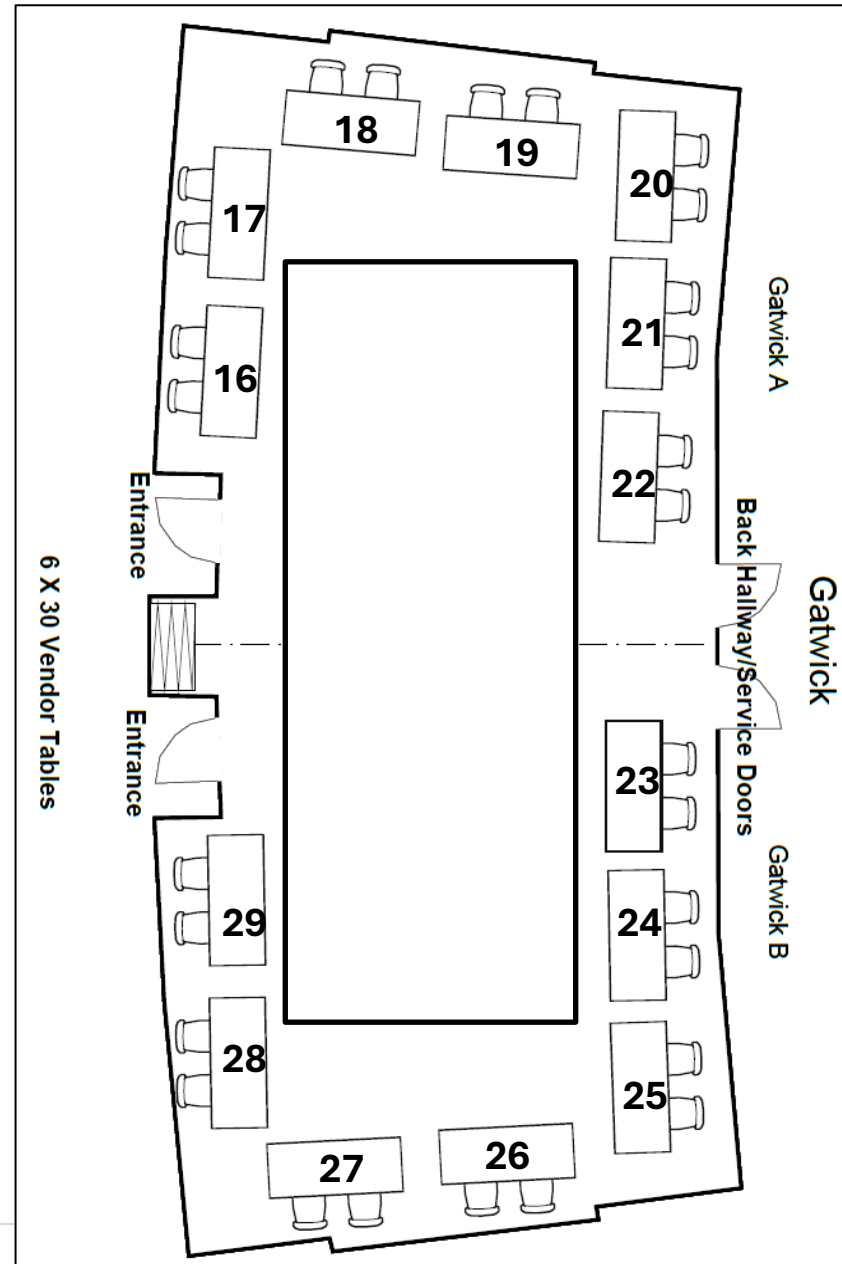
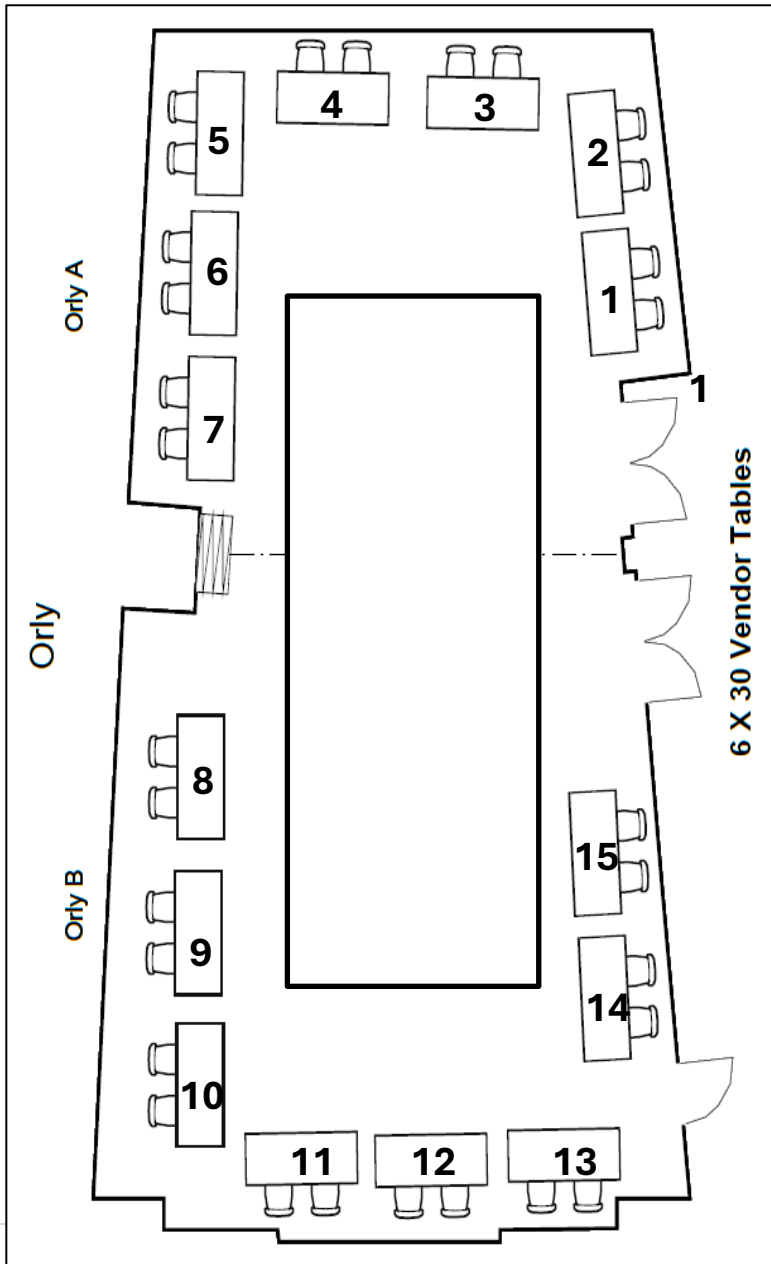

## Hotel Accommodations

The Renaissance St. Louis Airport Hotel offers a special group rate of \$129.00 for a one-night stay (This does not include the cost of the conference). When calling to make a reservation, identify yourself as a participant in the 2025 Bi-State Infectious Disease Conference. Special room rates are available until the block is sold out or September 4, 2025, whichever comes first. On-site parking is \$20 per day.

Check In: 4 PM    Check Out: 12 PM

### EARLY RESERVATIONS ARE STRONGLY RECOMMENDED.

Please call Renaissance St. Louis Airport Hotel at 314-429-1100 and mention the Bi-State Infectious Disease Conference. To book online go to [Bi-State Infectious Disease Group Room Block](#).



## Directions to the Hotel

- **From the West:** Take I-70 east to the Natural Bridge Road exit. The hotel is immediately after the first stop light on the left.
- **From the East:** Take I-70 to 170 South. Take the exit to Natural Bridge Road. Turn left (west) on Natural Bridge Road. The hotel entrance is approximately one mile west on the right.
- **From the South:** Take 170 North. Take the exit to Natural Bridge Road. Turn left (west) on Natural Bridge Road. The hotel entrance is approximately one mile west on the right.
- **From the North:** Take 170 South. Take the exit to Natural Bridge Road. Turn left (west) on Natural Bridge Road. The hotel entrance is approximately one mile west on the right.



# Rules and Regulations

In applying for exhibit space, exhibitors agree to abide by the following regulations:

## Exhibit Regulations

- Each exhibitor is responsible for compliance with the Americans with Disabilities Act (ADA) within its booth and assigned space.
- The attire of exhibit personnel should be consistent with the professional atmosphere of the convention.
- Exhibitors' demonstrations may not interfere with normal traffic flow or infringe on neighboring exhibits. Demonstrations are not permitted outside of the exhibitor's assigned booth space.
- Exhibitors cannot canvass or distribute advertising material outside their booth space.
- Canvassing or marketing any products or services in any part of the exhibition hall or meeting rooms by anyone representing a non-exhibiting firm is strictly prohibited.
- Exhibit space subletting and sharing are not permitted unless they are within divisions of the same company.
- The exhibitor is responsible for having all licenses, permits, and/or registrations required by the venue, city, municipality, and/or state and complying with all applicable tax laws.
- You must read and agree to the terms listed in the Exhibitor Prospectus.

## Terms and Conditions

- EXHIBITOR agrees that all promotional activities and materials must be appropriate for a professional audience and must not interfere with the event experience. Product-promotion materials and advertisements must be confined to the designated exhibit space. Promotional activities (live or digital) must not disrupt event programming or other exhibitors.
- EXHIBITOR may distribute educational and promotional materials only within their assigned exhibit space.
- All exhibit fees must be disclosed to and processed through the PROVIDER. No additional payments, gifts, services, or incentives may be provided to event organizers, planning committee members, speakers, or affiliated personnel.
- PROVIDER will assign exhibit space and reserves the right to relocate or reassign space at its discretion to ensure a balanced and professional exhibit environment.
- Completion of this agreement constitutes a binding commitment. EXHIBITOR agrees to remit full payment of all fees by the event date unless otherwise arranged with the PROVIDER. PROVIDER reserves the right to deny exhibit space in the event of nonpayment or violation of these terms.
- If cancellation occurs **45 days or more** before the event, PROVIDER will refund the exhibit fee minus a \$300 processing fee.
- If cancellation occurs **less than 45 days** before the event, the full exhibit fee is due and non-refundable.
- EXHIBITOR is expected to maintain professional conduct throughout the event. PROVIDER reserves the right to remove any exhibitor for behavior deemed inappropriate or disruptive, without a refund.

## Liability

- Missouri-Illinois Public Health Officials, APIC Chapter 73, nor the Mayo Clinic Center for Tuberculosis shall be responsible for injury, loss, or damage that may occur to the Exhibitor or his property from any cause whatsoever, prior to, during, or after the period of the Exhibit. The Exhibitor agrees to indemnify Missouri-Illinois Public Health Officials, APIC Chapter 73 and Mayo Clinic Center for Tuberculosis and their employees, volunteers, and committees from any and all claims for loss, damage, or injury. Exhibitors are encouraged to insure themselves against property loss or damage, and against both general and personal liability.
- Exhibitor understands and agrees that, for the safety of conference attendees, Exhibitor shall not perform any procedures or provide any services to conference attendees that are either invasive or are customarily performed in a practitioner's office.



We look forward to seeing you in St. Louis,  
Missouri for the 2025 Bi-State Infectious  
Disease Conference!